

Berkel

MANUAL

slicing machine model 836

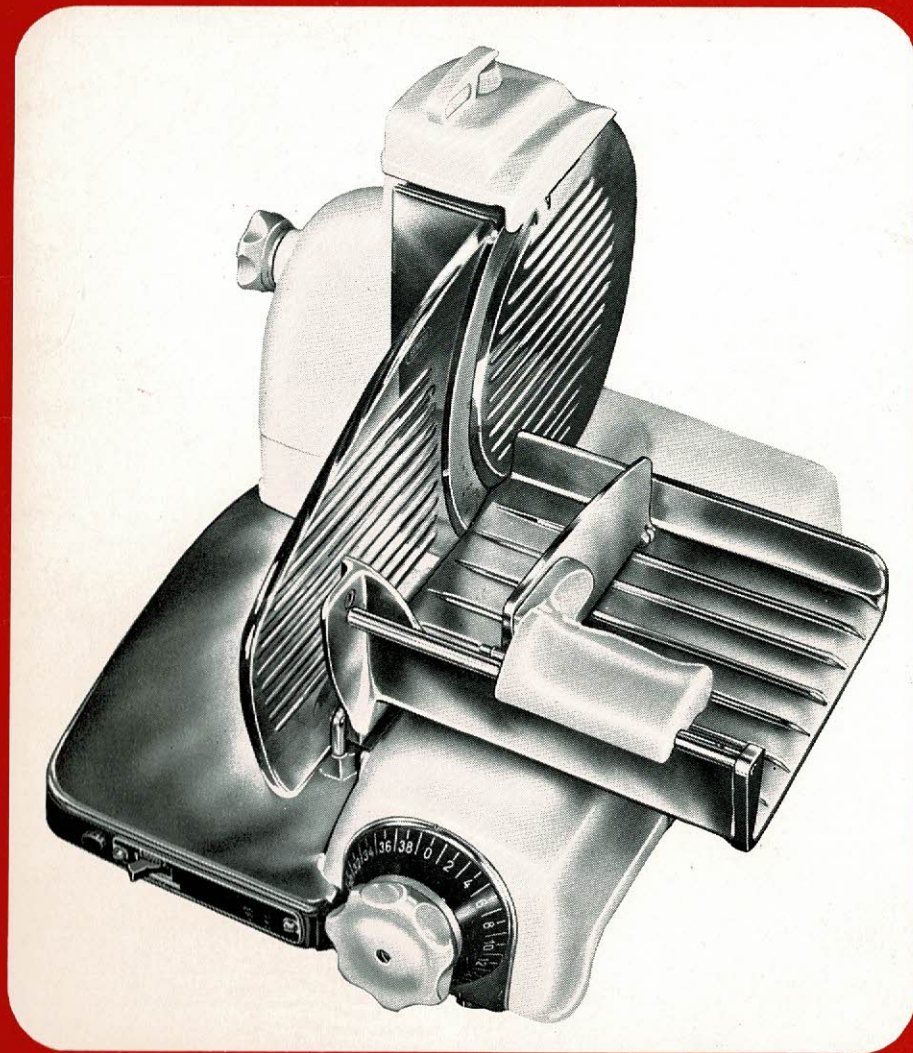

OPERATION

Move table to and fro, but do not exert more side-pressure than required for keeping product to be sliced against gauge plate.

MAINTENANCE

1. Thoroughly clean machine at least once a day after use and with Berkel-oil only.
Do not forget to set gauge plate at zero before starting to clean.
2. When cleaning machine it is recommended to sharpen knife a little — even if it should be sufficiently sharp. The advantage is:
 - a. the final traces of the sliced products, which practically always contain salts, are thoroughly removed from the knife-edge, thus preventing corrosion, when the machine is not in use.
 - b. the knife remains in perfect condition.

SHARPENING OF KNIFE

- **Unnecessarily long sharpening may spoil the knife and will shorten its life.**
- **Always clean knife before sharpening.**

Lift sharpener, turn clock-wise until it touches stop and lower over knife.

Switch on motor and push to the left, the lever situated to the left hand side under sharpener cover. Do this carefully with the thumb of the left hand and not for too long. Lever should be released after a few seconds.

Next turn sharpener to normal position and finally clean knife edge once again.

CLEANING

To facilitate cleaning various parts of the machine can be removed easily:

1. PUSHER

Is detachable in any position.

2. TABLE

Pull table to the front until it touches springloaded stop; next pull a little stronger so that spring is compressed when table can be flapped to the right.

3. CENTRE PLATE

Unscrew grey knob at left hand side of knife box. Grip rear of centre plate with right hand and remove centre plate at an oblique angle backwards to the right.

4. KNIFE SHIELD

Flap knife shield which is fitted at the left hand side of the knife, to the left. Now knife can be cleaned on both sides by means of a cloth and a little Berkel-oil.

5. SHARPENER

To ensure correct operation, stones should be cleaned regularly.

For this purpose sharpener is taken from machine by turning it clock-wise through an angle of 90° and lifting it. Remove cover by unscrewing knurled knob in grip.

The stones should be cleaned by brushing them with Berkel-oil.

Stones will be more easily cleaned if always kept soaked with Berkel-oil.

LUBRICATION

Completely unnecessary!

THE MACHINE IS SELF-LUBRICATING THROUGHOUT.

TECHNICAL INSTRUCTIONS

ADJUSTMENT OF SHARPENER

see illustrations on pages 8 and 11

When fitting a new knife the inside stone should overlap knife by 8 mm ($\frac{5}{16}$ " (illustration A - page 8). When as a result of the sharpening of the knife, this distance has been reduced to 5 mm ($\frac{3}{16}$ " or less, the height of the sharpener in grinding position has to be adjusted accordingly.

To this end nut M 705 is turned until inside stone overlaps knife by approximately 8 mm ($\frac{5}{16}$ " again.

The correct position for precision sharpening is dependent on stop plate 836—2051, which plate is adjusted and secured at the factory by means of a pin so that inside stone always touches edge of knife correctly.

When inside stone is correctly adjusted knife edge should show a so called "cross stitch" after sharpening.

When replacing stones, these will be supplied inclusive of spindle so as to ensure correct position in relation to knife.

ADJUSTMENT OF GAUGE PLATE

see illustrations on pages 15, 17 and 23

The gauge plate will have to be readjusted in relation to the knife, after the diameter of the latter has been reduced by about 5 mm ($\frac{3}{16}$ " as a result of regular sharpening.

To this end screws S 1061 are unscrewed a little and the gauge plate is relocated in a horizontal direction until the distance of gauge plate to knife edge amounts to 1.5 mm ($\frac{1}{16}$ " or 2 mm ($\frac{5}{64}$ "). Please note that the index knob should be set on zero.

The distances between knife-edge and top and bottom points of gauge plate respectively should also be the same, and the gauge plate may have to be slightly turned on its own plane so that the clearance between edges of gauge plate and knife match exactly.

Next screws S 1061 should be tightened securely again. To readjust the zero position of index knob and gauge plate, cover 836—1101 is removed. The bolts S 940 are unscrewed $\frac{1}{2}$ turn and adjustment bolt S 1083 is unscrewed a little as well.

Now gauge plate shaft 836—G 9036 can be relocated in a lengthwise direction not forgetting to retighten bolts S 940 and S 1083 after the adjustment.

Take care however that shaft does not turn as otherwise gauge plate could touch knife edge.

Further it should be noted that screws S 1061, S 940 and S 1083 should never be unscrewed at the same time, as otherwise the factory adjustment of the plane of the gauge plate in relation to that of the knife would be lost.

REPLACEMENT OF KNIFE

see illustrations on pages 13 and 15

Unscrew screws S 1061 and push the gauge plate backwards. Remove screws S 1040 and take knife from shaft.

Attention: The knife is quite sharp and should be handled with care; it should be placed on a flat table with its convex side up.

Before fitting of new knife, carefully clean spindle, hole in knife and bearing surface of knife, as otherwise knife might run untrue.

After fitting of new knife, gauge plate will have to be readjusted.

SLIDE RAIL OF TABLE

see illustrations on pages 8, 15 and 21

The guide block 836—G 1002 should also be adjusted with hardly any horizontal play in relation to the table.

This is done by unscrewing screw S 1054 after which the adjustment can be effected by means of adjustment screw S 1075. Do not forget to tighten screw S 1054 afterwards.

Between table and knife edge a clearance of at least 0.5 mm (.02") should be kept (illustration B - page 8). Adjustment is obtained by means of screws S 1060.

ASSEMBLY OF HOUSING

see illustration on page 17

Cover 836—G 1099 is placed on the frame and front plate 836—9040 is fitted to the front. Do not forget to fit closing plate 836—1087 underneath shaft of gauge plate.

Whilst tightening screws S 756 press the cover downwards and the front plate upwards.

Next the front of motor housing 836—2002 is fitted by means of screws S 764. Press this part downwards during tightening of screws as well.

Bracket 836—2071 is fitted to side of frame, so that cover 836—G 1099 is held down also at that side.

Then bolt S 619 at the rear can be tightened. Only if assembled strictly according to above instructions will the cover 836—G 1099 perfectly match the receiving tray

Now the motor housing 836—2024 can be fitted.

When removing the various parts of the housing, screws S 1062 of the motor housing and screw S 1054 of closing plate 836—1087 only need to be unscrewed a few turns.

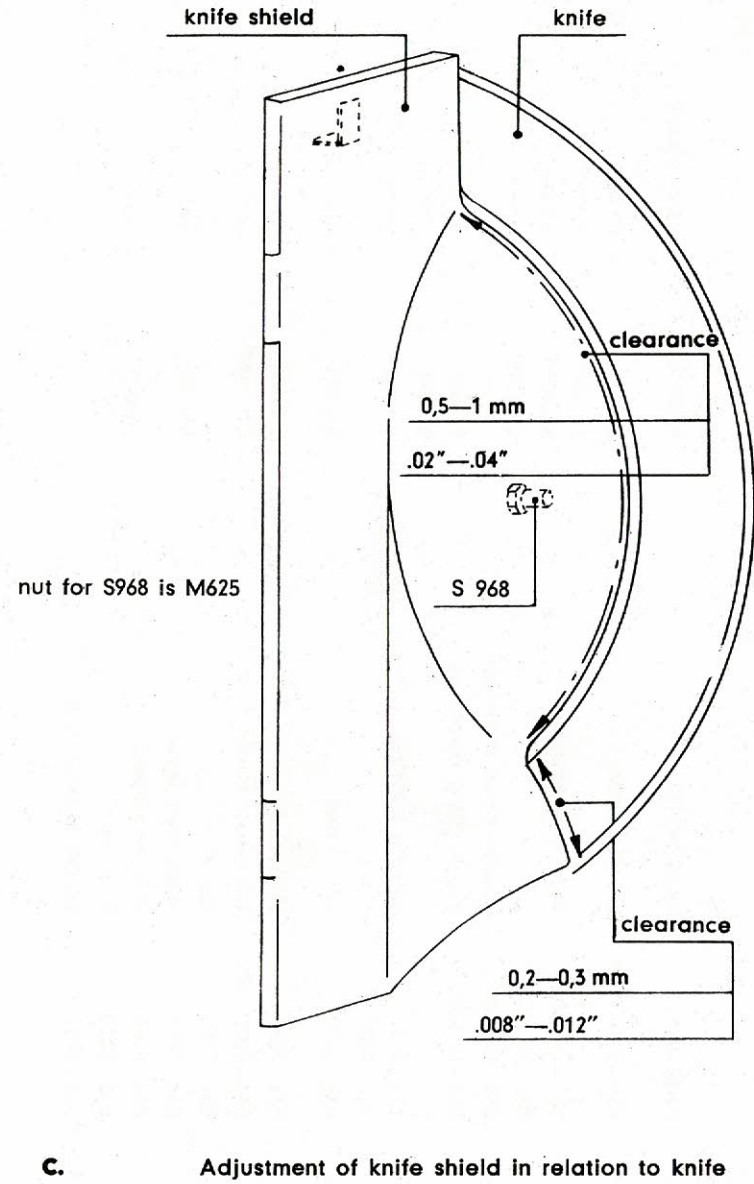
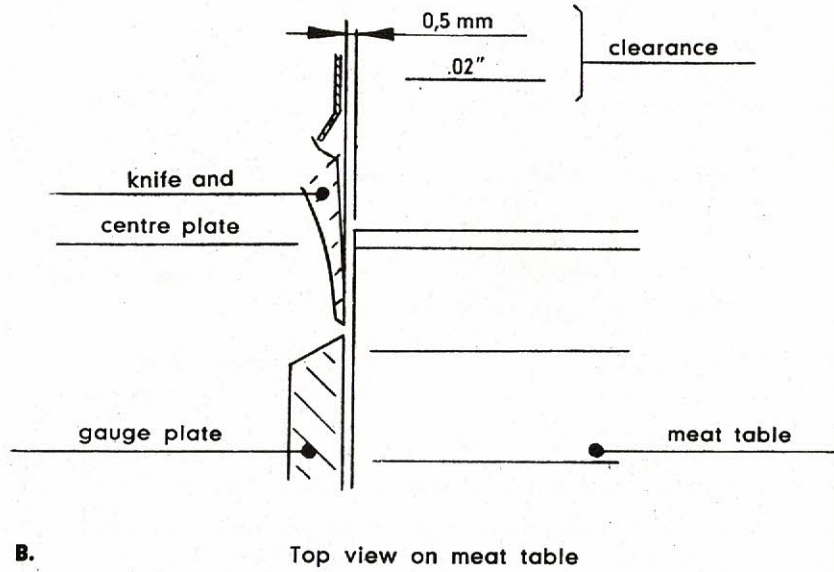
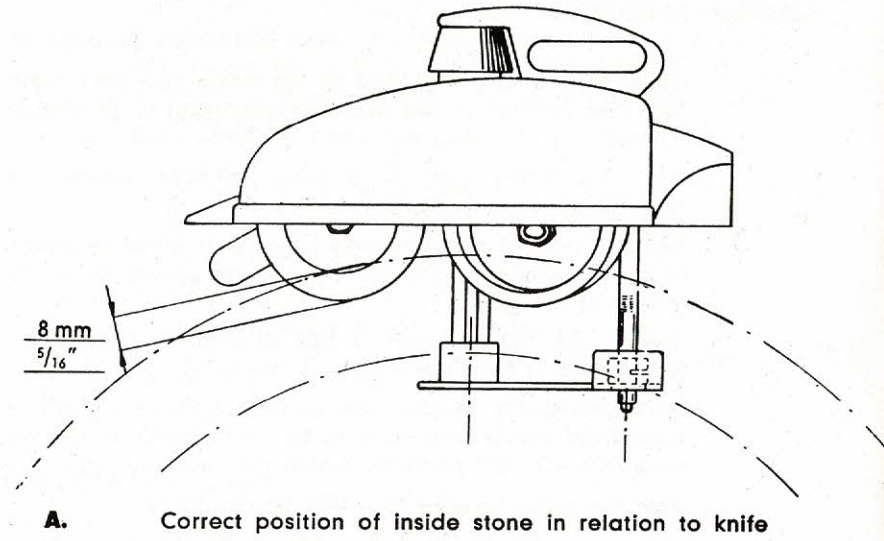

PART NO.	PART NAME
836-G 2009	centre plate knob
836-G 2019	centre plate
836-2030	knife
836-2055	cover
S-1040	screw
R-657	washer
R-801	locking ring

Note: When ordering parts please do state serial number and model of machine!!

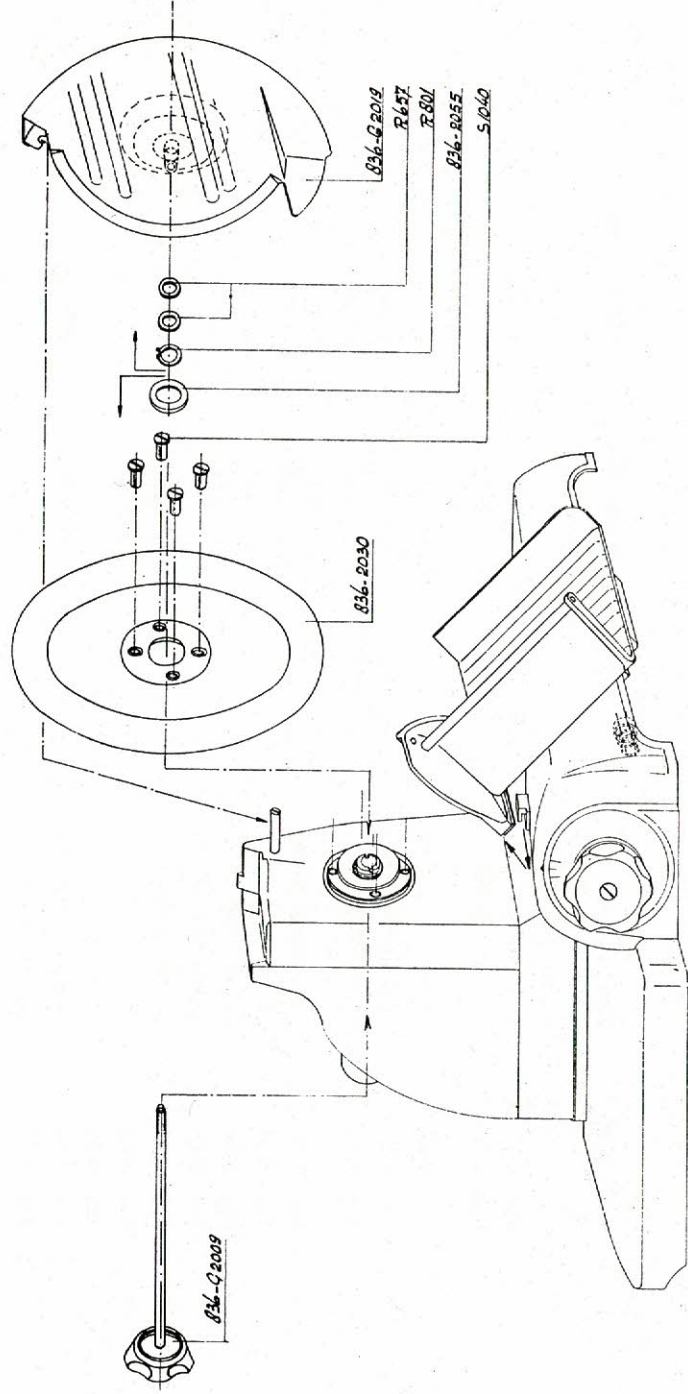

PART NO.	PART NAME	PART NO.	PART NAME
836-G 1002	guide block	S-637	screw
836-G 2003	knife shield	S-655	screw
836-G 4002	pusher handle	S-756	screw
834-9004	boss	S-968	screw
834-9005	index scale	S-920	screw
834-9014	index knob	S-993	screw
836-1099	adjustment plate	S-1054	screw
836-3001	table	S-1057	screw
836-3004	guide strip	S-1060	screw
836-3005	guide bar	S-1061	screw
836-4003	pusher plate	S-1075	screw
836-4052	pin	R-617	washer
836-4055	roller	R-626	washer
836-9036	gauge plate strip	M-625	nut
836-9037	gauge plate		

Note: When ordering parts please do state serial number and model of machine !!

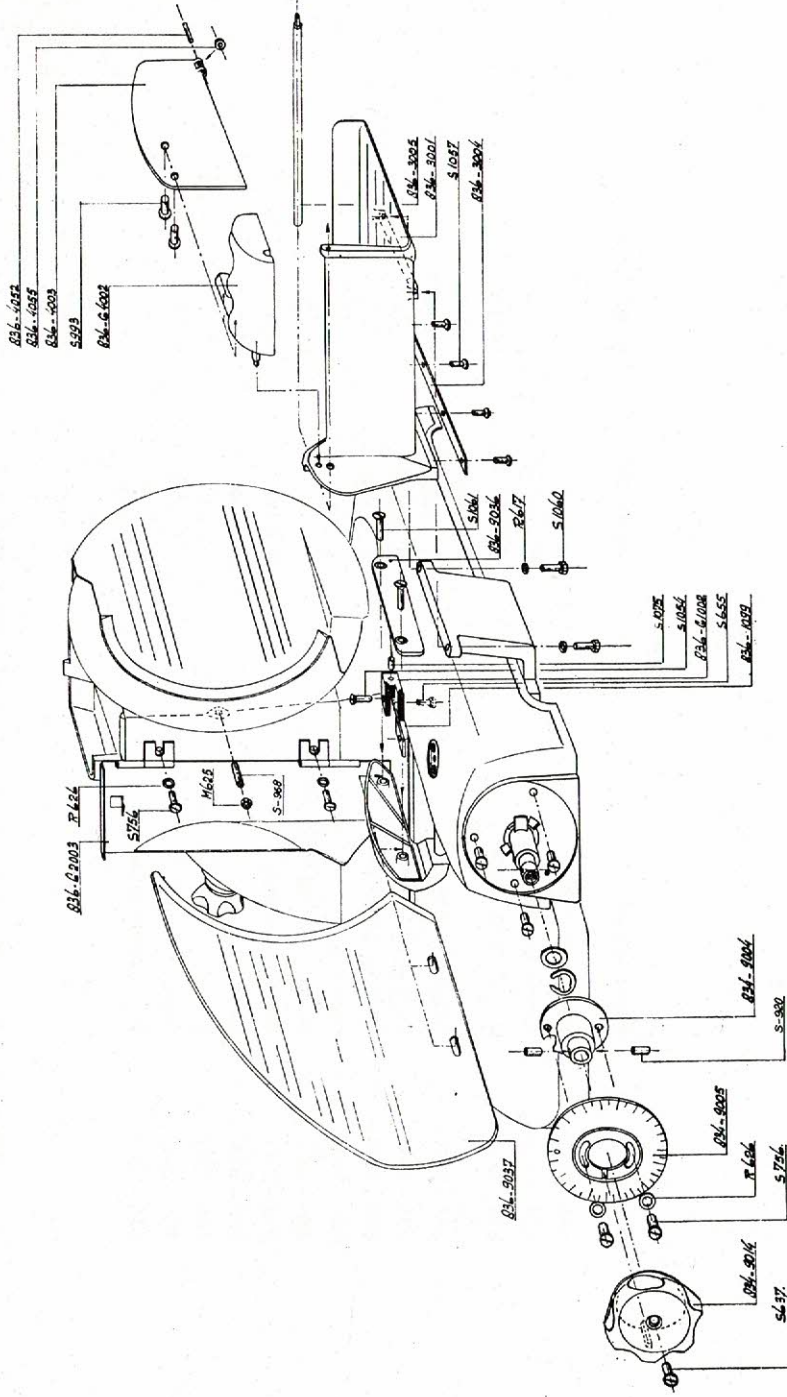

PART NO.	PART NAME	PART NO.	PART NAME
836-G 1099	cover	S-619	screw
836-G 2020	fixing bracket	S-671	screw
836-G 2021	connecting piece	S-756	screw
836-1087	closing plate	S-764	screw
836-1088	connecting clip	S-1051	screw
836-1089	closing plate strip	S-1054	screw
836-1101	dust cap	S-1056	screw
836-2002	motor housing front piece	S-1062	screw
836-2024	motor housing	R-617	washer
836-2050	bush	R-706	washer
836-2069	pin	VV-725	spring
836-2071	locking plate	M-636	nut
836-9040	index front plate	K-006	rivet

Note: When ordering parts please do state serial number and model of machine!!

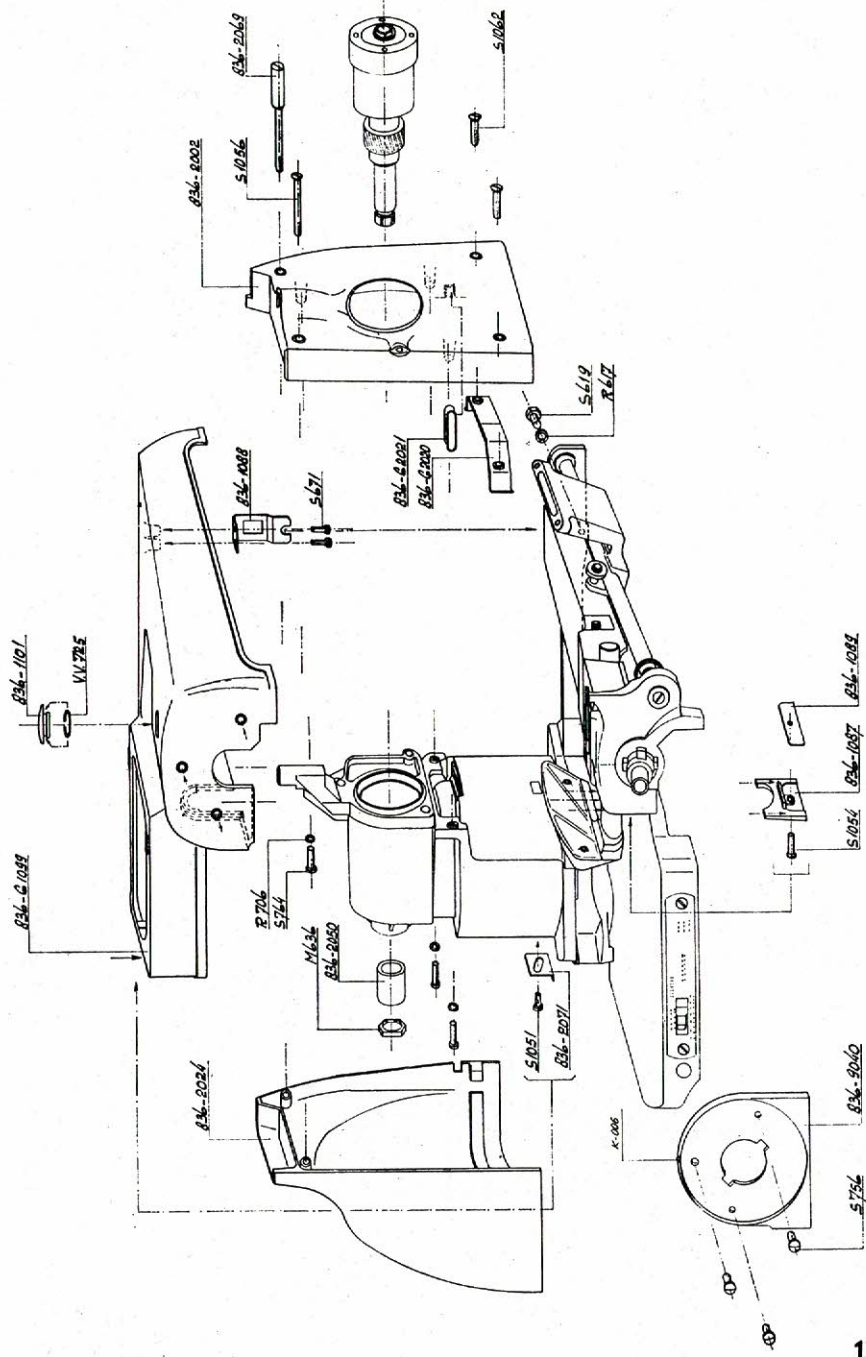

PART NO.	PART NAME	PART NO.	PART NAME
836-2001	gear frame	R-617	washer
836-2015	knife shaft	R-746	washer
836-2053	end cover	R-828	washer
836-2056	cover ring	R-793	washer
836-2057	worm	R-812	washer
836-2058	helical gear	R-799	washer
836-2062	spring cap	VV-720	spring
836-2070	rubber cap	VV-721	spring
836-2073	grid	L-053	ball bearing
836-2076	knife shaft bearing housing	A-004	key for knife shaft
S-943	screw	A-064	circlip
S-1052	screw	A-080	circlip
S-1055	screw	A-081	circlip
S-1058	screw	A-083	circlip
		A-088	circlip
		E-302	motor 220 volts-50 cycles
		E-303	motor 127 volts-50 cycles
		E-304	motor 115 volts-60 cycles

Note: When ordering parts please do state serial number and model of machine!!

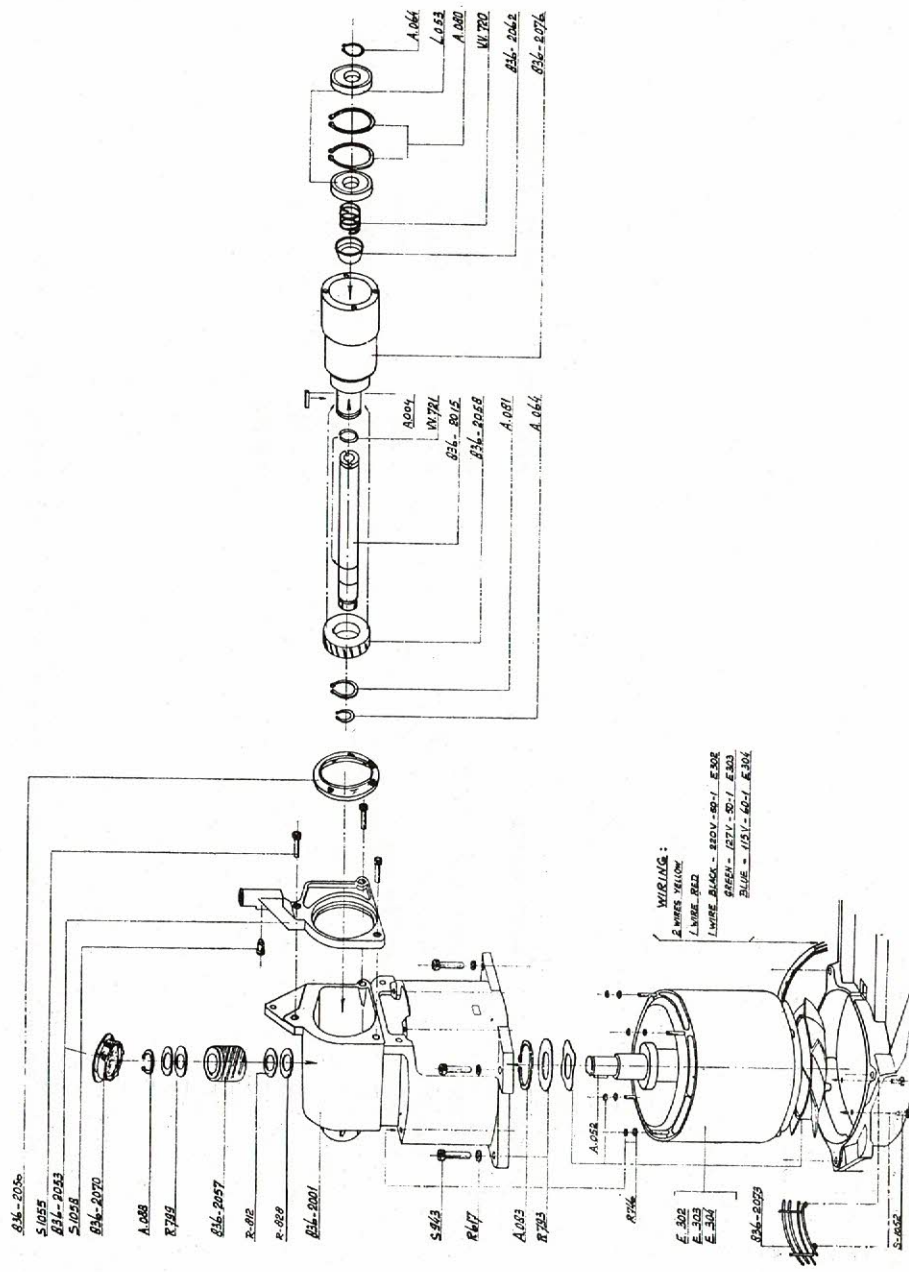

PART NO.	PART NAME	PART NO.	PART NAME
836-1021	carriage	S-638	screw
836-1023	bearing	R-790	washer
836-1025	guide bar	R-796	washer
		R-810	washer
		P-781	pin
		VV-761	spring
		VV-762	spring

Note: When ordering parts please do state serial number and model of machine!!

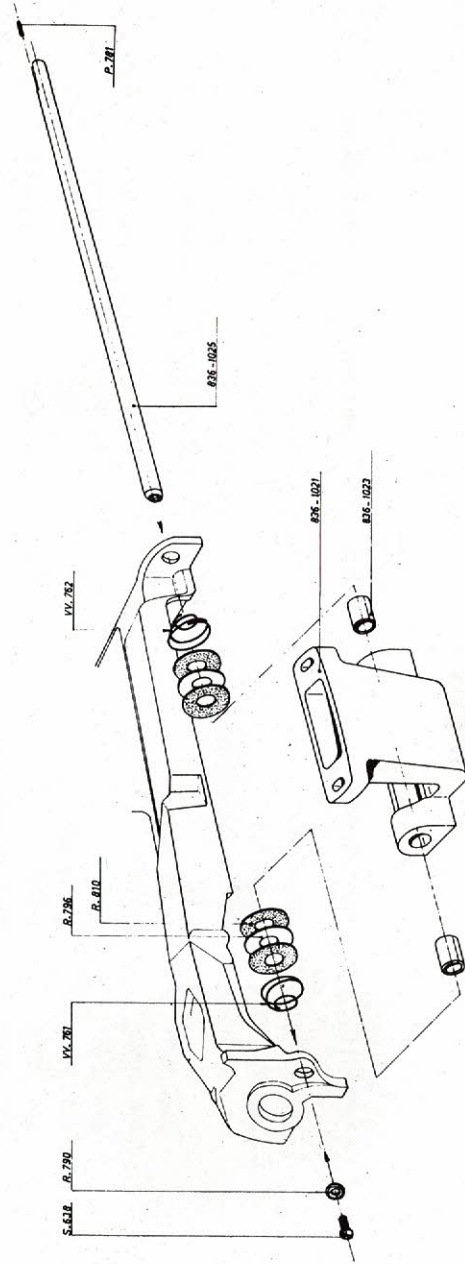

PART NO.	PART NAME	PART NO.	PART NAME
836-G 9002	index cam	S-633	screw
836-G 9004	index fork	S-1083	screw
836-G 9036	gauge plate bracket	S-940	bolt
836-1020	main frame	S-1053	screw
836-1080	boss	R-728	circlip
836-1100	bush	R-782	washer
836-9002	guide pin	R-783	washer
836-9010	roller	R-800	washer
836-9028	friction plug	M-707	nut
836-9041	flat spring	A-082	rubber foot
		A-087	rubber foot

Note: When ordering parts please do state serial number and model of machine!!

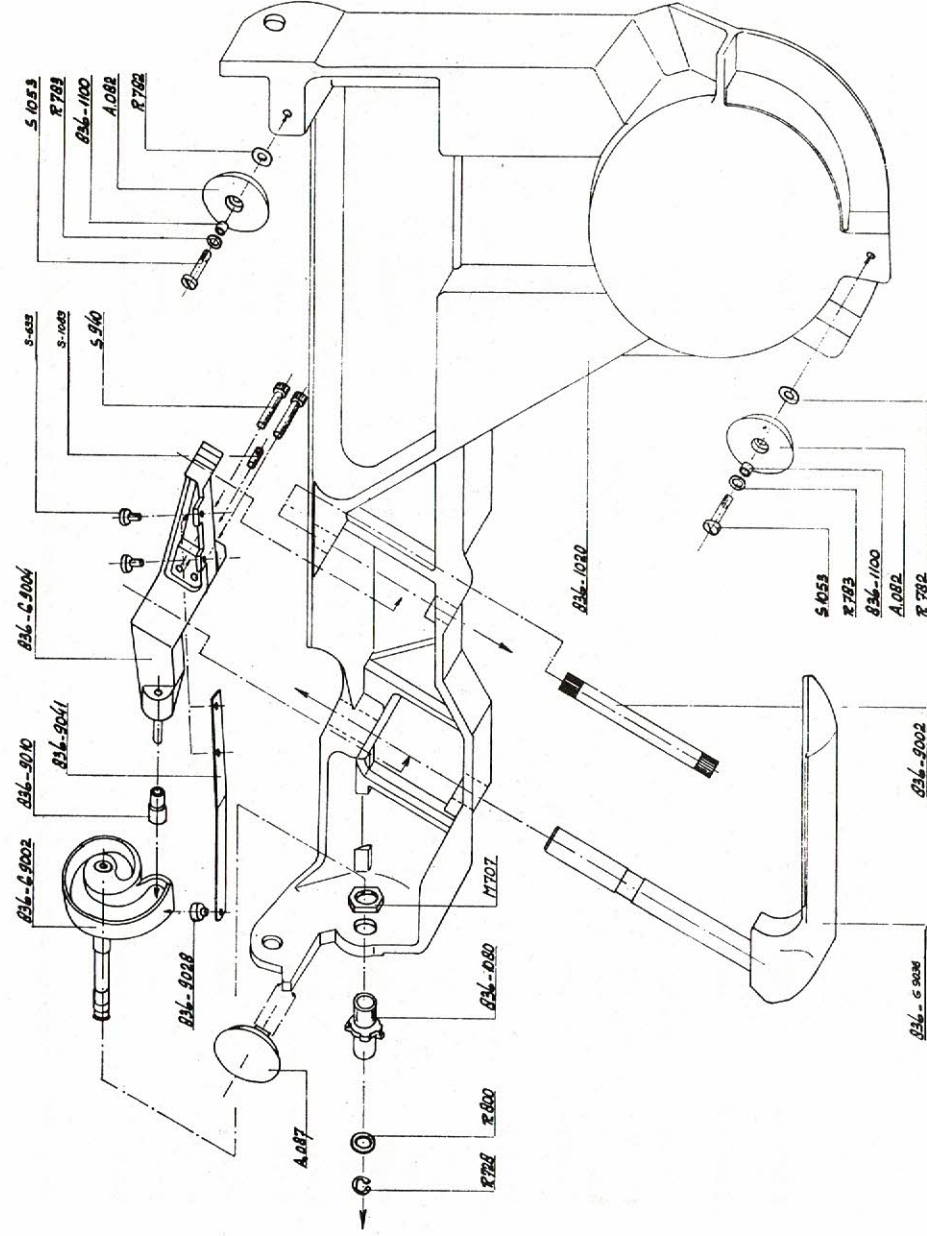



This booklet is the
property of
MAATSCHAPPIJ VAN BERKEL'S PATENT B.V.
Rotterdam - The Netherlands